

VENEER UNITS

Notes:

- All sizes shown as Width x Height x Length. Other sizes may be available from some manufacturers.
- Many special shapes are also available. See your masonry manufacturer for more information.
- Thickness of mortar joints between units can be adjusted slightly by the mason to fit required length/height dimensions.

Size	Metric (mm)	Imperial (in)
------	-------------	---------------

STANDARD

Actual Size	90 x 64 x 190	3½ x 2½ x 7½
Nominal Size	100 x 75 x 200	4 x 3 x 8
Coursing	4c = 300mm	4c = 12 in
Number of Units	66.7 per m ²	6.0 per ft ²

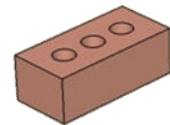

MODULAR

Actual Size	90 x 57 x 190	3⅝ x 2¼ x 7⅝
Nominal Size	100 x 67 x 200	4 x 2⅔ x 8
Coursing	3c = 200mm	3c = 8 in
Number of Units	75 per m ²	6.75 per ft ²

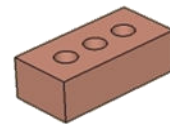

NORMAN

Actual Size	90 x 64 x 290	3½ x 2½ x 11½
Nominal Size	100 x 75 x 300	4 x 3 x 12
Coursing	4c = 300mm	4c = 12 in
Number of Units	44.5 per m ²	4.0 per ft ²

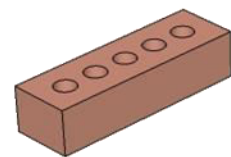

ECON / SAXON

Actual Size	90 x 90 x 290	3½ x 3½ x 11½
Nominal Size	100 x 100 x 300	4 x 4 x 12
Coursing	2c = 200mm	2c = 8 in
Number of Units	33.3 per m ²	3.0 per ft ²

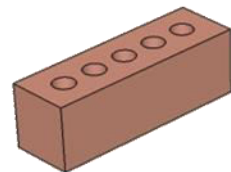

GIANT

Actual Size	90 x 90 x 390	3½ x 3½ x 15½
Nominal Size	100 x 100 x 400	4 x 4 x 16
Coursing	2c = 200mm	2c = 8 in
Number of Units	25 per m ²	2.25 per ft ²

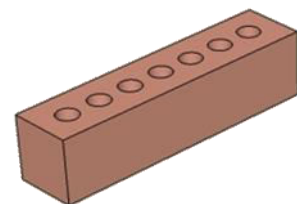

STRUCTURAL UNITS

See Section 1.2.1 for information on structural design.

Metric (mm)

Imperial (in)

300 (12") STRUCTURAL

90 x 90 x 290	3½ x 3½ x 11½
140 x 90 x 290	5½ x 3½ x 11½
190 x 90 x 290	7½ x 3½ x 11½
(Nominal 100x300)	(Nominal 4x12)

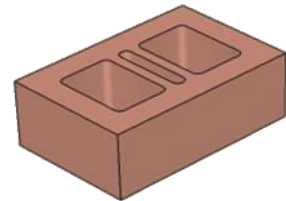

400 (16") STRUCTURAL

90 x 90 x 390	3½ x 3½ x 15½
140 x 90 x 390	5½ x 3½ x 15½
190 x 90 x 390	7½ x 3½ x 15½
(Nominal 100x400)	(Nominal 4x16)

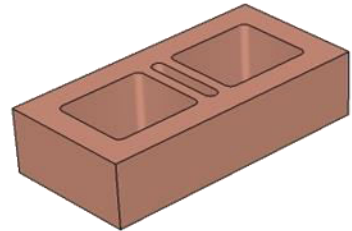

SAMPLE SHAPES

See manufacturer for full range of available shapes.

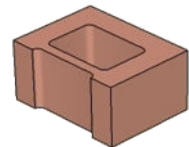
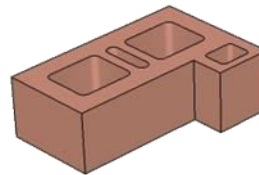
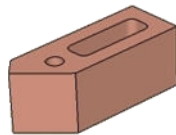
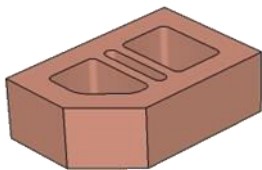

Examples of walls in running bond (half bond) using face brick of different sizes.

Standard Brick

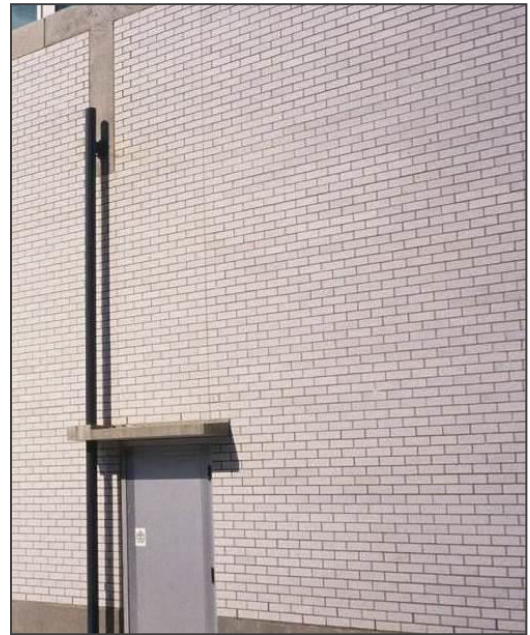
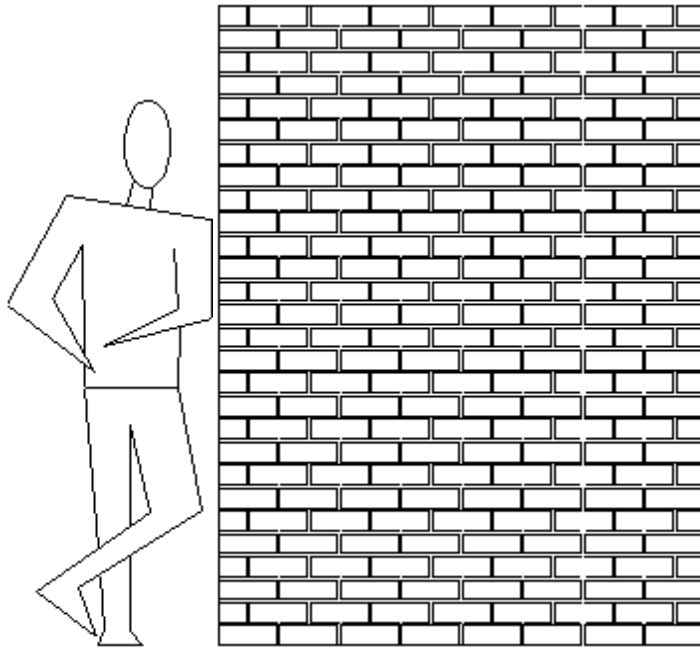

Norman Brick

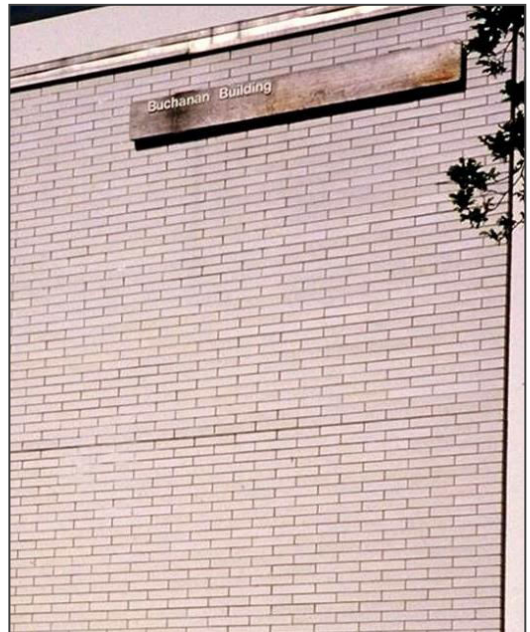
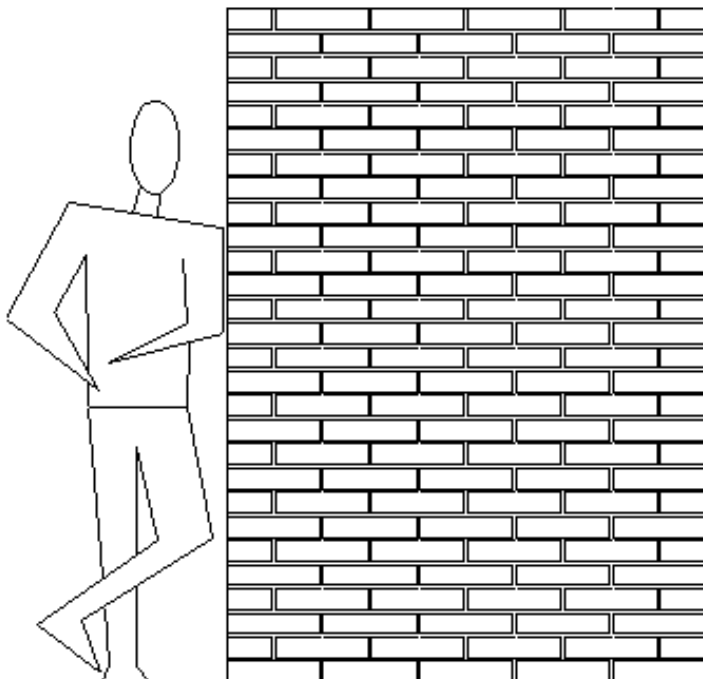

Econ / Saxon Brick

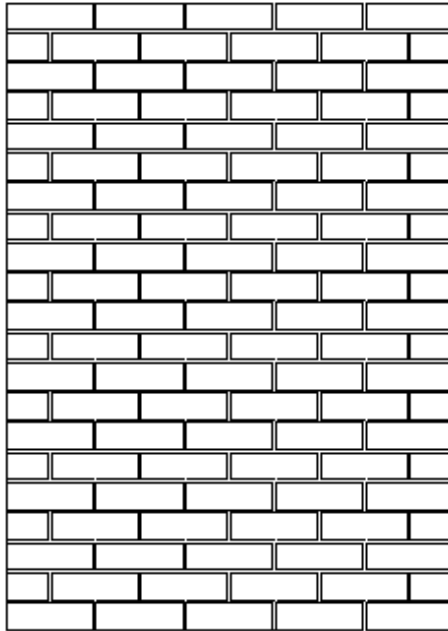
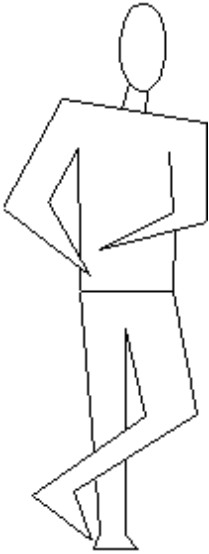

Giant Brick

