

**NOTES:**

- CLIP ANGLE LOCATION COINCIDES WITH VERTICAL REINFORCEMENT
- BOND BEAM IN THE SECOND LAST COURSE TO ALLOW SPACE FOR GROUTING
- OPEN END UNIT AND STIFF GROUT USED TO FILL VERTICALLY REINFORCED CELL IN TOP COURSE
- ANGLE CLIPS ARE FASTENED TO SLAB ABOVE (AND NOT TO BLOCK)
- FIRE STOPPING / SOUND PROOFING MAY BE REQUIRED AT TOP OF WALL TO CLOSE DEFLECTION SPACE

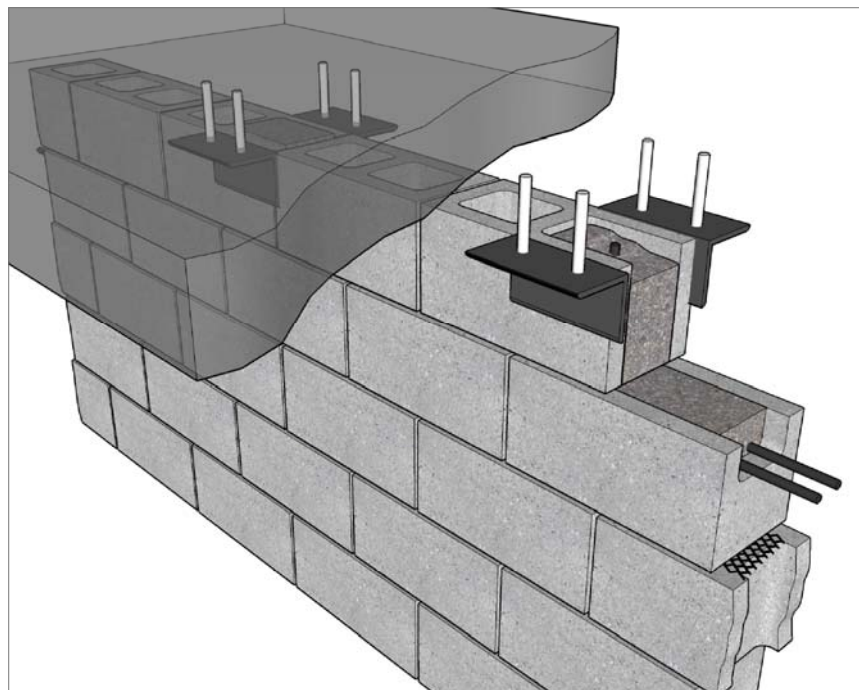

DT.3.1